

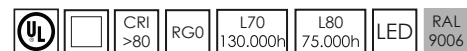

# MAXI-PLANET



Apparecchio per illuminazione stradale. Corpo in alluminio trafilato ossidato, vetro temperato trasparente spessore 5 mm, guarnizione in silicone, alimentatore elettronico 230V. Attacco palo incluso nella confezione. Prodotto in conformità alle vigenti norme EN / IEC 60598-1:2015.

Street light fitting. Extruded aluminium oxydate body, tempered transparent glass mm 5 thickness, silicon gasket, electronic ballast 230V. Pole bracket included. Fitting manufactured according to the EN / IEC 60598-1:2015 rules.

## CODIFICA/CODE

Art.	+	Mod.	+	°K	+	W-tot	+	Opt.
9010		L2		4 = 4000°K		120		EL = standard
				5 = 5000°K		130		LM = 1-10v
				S = sap-led		150		LD = dali
								MD = mezzanotte virtuale/virtual midnight

## ACCESSORI/ACCESSORIES

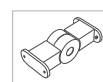

ST01



AP02

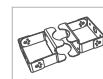

AP03

## DIMENSIONI/DIMENSION

	A	B	C	Kg	mc		
D1	280	535	90	9,0	0,016	1	50

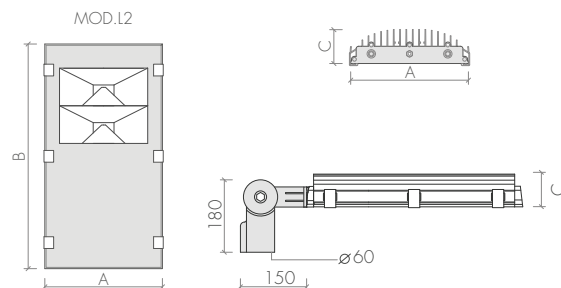



## mod/L2

### Offiche e diffusori

Riflettore in alluminio satinato. Asimmetria 60°.

### Louvers and diffusers

Matt satin aluminium reflector. 60° Asymmetry.

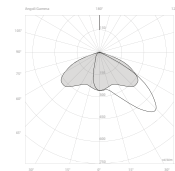

IP66 850° IK08

- 4000°K = standard
- 5000°K = +0.90% lm
- SAP-LED = -17.50% lm

W-Tot.	Lm (Tc=25°) 4000°K	Lm (Output)	Sost.	Dimension
120	18682	13237	250W JM-MH	D1
130	20718	15538	250W SAP-HPS	D1
150	23610	17708	400W JM-MH	D1



ATTACCO PALO REGOLABILE  
INCLUSO PER PALI Ø 60 MM

ADJUSTABLE POLE BRACKET  
INCLUDED FOR Ø 60 MM