

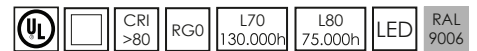

PLANET



Apparecchio per illuminazione stradale. Corpo in alluminio trafilato ossidato, vetro temperato trasparente spessore 5 mm, guarnizione in silicone, alimentatore elettronico 230V. Attacco palo incluso nella confezione. Prodotto in conformità alle vigenti norme EN / IEC 60598-1:2015.

Street light fitting. Extruded aluminium oxydate body, tempered transparent glass mm 5 thickness, silicon gasket, electronic ballast 230V. Pole bracket included. Fitting manufactured according to the EN / IEC 60598-1:2015 rules.

CODIFICA/CODE

Art.	+	Mod.	+	°K	+	W-tot	+	Opt.
9009		L1		4 = 4000°K		020		EL = standard
		L2		5 = 5000°K		030		LM = 1-10v
				S = sap-led		040		LD = dali
						050		MD = mezzanotte virtuale/virtual midnight
						080		
						100		

ACCESSORI/ACCESSORIES

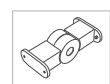

ST01



AP02

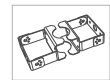

AP03

DIMENSIONI/DIMENSION

	A	B	C	Kg	mc		
D1	280	225	90	4,0	0,068	1	50
D2	280	315	90	6,5	0,094	1	50

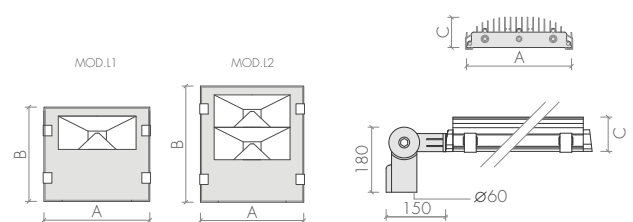



mod/L1

Offiche e diffusori
Riflettore in alluminio satinato. Asimmetria 60°.

Louvers and diffusers
Matt satin aluminium reflector. 60° Asymmetry.



IP66 850° IK08

- 4000°K = standard
- 5000°K = +0.90% lm
- SAP-LED = -17.50% lm

W-Tot.	Lm (Tc=25°) 4000°K	Lm (Output)	Sost.	Dimension
20	3214	2277	300W halog.	D1
30	4518	3201	70W JM-MH	D1
40	5827	4128	70W SAP-HPS	D1
50	7081	5017	500W halog.	D1



ATTACCO PALO REGOLABILE
INCLUSO PER PALI Ø 60 MM

ADJUSTABLE POLE BRACKET
INCLUDED FOR Ø 60 MM



mod/L2

Offiche e diffusori
Riflettore in alluminio satinato. Asimmetria 60°.

Louvers and diffusers
Matt satin aluminium reflector. 60° Asymmetry.

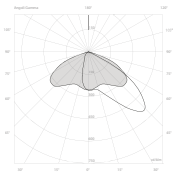

IP66 850° IK08

- 4000°K = standard
- 5000°K = +0.90% lm
- SAP-LED = -17.50% lm

W-Tot.	Lm (Tc=25°) 4000°K	Lm (Output)	Sost.	Dimension
80	12420	8800	150W JM-MH	D2
100	14163	10035	150W SAP-HPS	D2



ATTACCO PALO REGOLABILE
INCLUSO PER PALI Ø 60 MM

ADJUSTABLE POLE BRACKET
INCLUDED FOR Ø 60 MM