



# STEALTH 2 BY momoDESIGN



Apparecchio per illuminazione stradale. Corpo in alluminio pressofuso verniciato con polvere termoindurente poliestere anticorrosione colore antracite, vetro temperato trasparente spessore 5 mm, guarnizione in silicone, alimentatore elettronico 230V. Attacco palo incluso nella confezione. Prodotto in conformità alle vigenti norme EN / IEC 60598-1:2015.

Street light fitting. Die cast aluminium body, painted with polyester coated anticorrosion powder anthracite color, tempered transparent glass mm 5 thickness, silicon gasket, electronic ballast 230V. Pole bracket included. Fitting manufactured according to the EN / IEC 60598-1:2015 rules.

## CODIFICA/CODE

Art.	+	Mod.	+	°K	+	W-tot	+	Opt.
9008		U0		4 = 4000°K		090		EL = standard
		C0		5 = 5000°K		100		LM = 1-10v
		E0				120		LD = dali
						130		MD = mezzanotte virtuale/virtual midnight
						150		
						160		

## ACCESSORI/ACCESSORIES

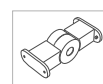

ST01EL



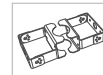

AP02EL



AP03EL

## DIMENSIONI/DIMENSION

	A	B	C	Kg	mc		
D1	333	600	96	8,5	0,023	1	50

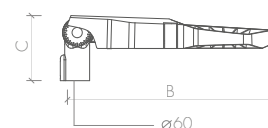
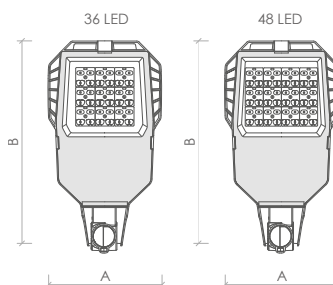



## mod/U0

### Optiche e diffusori

Lenti stradali in PMMA con fascio per strade urbane. Asimmetria 45°. Riflettore in alluminio satinato.

### Louvers and diffusers

Road lenses in PMMA with urban roads beam. 45° asymmetry. Matt satin aluminium reflector.

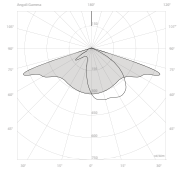

IP66 850° IK08

- 4000°K = standard
- 5000°K = +0.50% lm

W-Tot.	Lm (Tc=25°) 4000°K	Lm (Output)	Sost.	Dimension
90	13544	11929	250W merc-HG	D1
100	14922	13143	150W SAP-HPS	D1
120	16862	14852	250W JM-MH	D1
130	19445	17127	250W SAP-HPS	D1
150	21644	19064	400W JM-MH	D1
160	22483	19803	400W SAP-HPS	D1



## mod/C0

### Optiche e diffusori

Lenti stradali in PMMA con fascio per ciclopdonali. Angolo 150°. Riflettore in alluminio satinato.

### Louvers and diffusers

Road lenses in PMMA with cycle paths beam. 150° angle beam. Matt satin aluminium reflector.

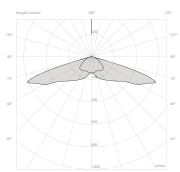

IP66 850° IK08

- 4000°K = standard
- 5000°K = +0.50% lm

W-Tot.	Lm (Tc=25°) 4000°K	Lm (Output)	Sost.	Dimension
90	13544	10699	250W merc-HG	D1
100	14922	11788	150W SAP-HPS	D1
120	16862	13320	250W JM-MH	D1
130	19445	15361	250W SAP-HPS	D1
150	21644	17098	400W JM-MH	D1
160	22483	17761	400W SAP-HPS	D1



## mod/E0

### Optiche e diffusori

Lenti stradali in PMMA con fascio per strade extraurbane. Asimmetria 60°. Riflettore in alluminio satinato.

### Louvers and diffusers

Road lenses in PMMA with highway beam. 60° asymmetry. Matt satin aluminium reflector.

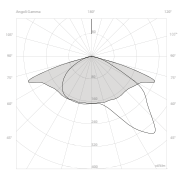

IP66 850° IK08

- 4000°K = standard
- 5000°K = +0.50% lm

W-Tot.	Lm (Tc=25°) 4000°K	Lm (Output)	Sost.	Dimension
90	13544	11158	250W merc-HG	D1
100	14922	12294	150W SAP-HPS	D1
120	16862	13892	250W JM-MH	D1
130	19445	16020	250W SAP-HPS	D1
150	21644	17832	400W JM-MH	D1
160	22483	18523	400W SAP-HPS	D1



# STEALTH 2 BY MOMODESIGN



Apparecchio per illuminazione stradale. Corpo in alluminio pressofuso verniciato con polvere termoindurente poliestere anticorrosione colore silver, vetro temperato trasparente spessore 5 mm, guarnizione in silicone, alimentatore elettronico 230V. Attacco palo incluso nella confezione. Prodotto in conformità alle vigenti norme EN / IEC 60598-1:2015.

Street light fitting. Die cast aluminium body, painted with polyester coated anticorrosion powder silver color, tempered transparent glass mm 5 thickness, silicon gasket, electronic ballast 230V. Pole bracket included. Fitting manufactured according to the EN / IEC 60598-1:2015 rules.

## CODIFICA/CODE

Art.	+	Mod.	+	°K	+	W-tot	+	Opt.
9008		U0		4 = 4000°K		090		GL = standard
		C0		5 = 5000°K		100		GM = 1-10v
		E0				120		GD = dali
						130		MG = mezzanotte virtuale/virtual midnight
						150		
						160		

## ACCESSORI/ACCESSORIES

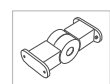

ST01GL



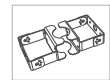

AP02GL



AP03GL

## DIMENSIONI/DIMENSION

	A	B	C	Kg	mc		
D1	333	600	96	8,5	0,023	1	50

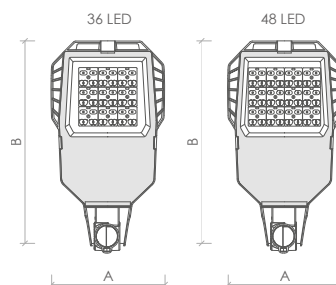



## mod/U0

### Optiche e diffusori

Lenti stradali in PMMA con fascio per strade urbane. Asimmetria 45°. Riflettore in alluminio satinato.

### Louvers and diffusers

Road lenses in PMMA with urban roads beam. 45° asymmetry. Matt satin aluminium reflector.

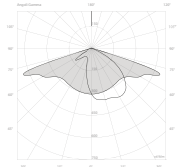

IP66 850° IK08

- 4000°K = standard
- 5000°K = +0.50% lm

W-Tot.	Lm (Tc=25°) 4000°K	Lm (Output)	Sost.	Dimension
90	13544	11929	250W merc-HG	D1
100	14922	13143	150W SAP-HPS	D1
120	16862	14852	250W JM-MH	D1
130	19445	17127	250W SAP-HPS	D1
150	21644	19064	400W JM-MH	D1
160	22483	19803	400W SAP-HPS	D1



## mod/C0

### Optiche e diffusori

Lenti stradali in PMMA con fascio per ciclopeditoni. Angolo 150°. Riflettore in alluminio satinato.

### Louvers and diffusers

Road lenses in PMMA with cycle paths beam. 150° angle beam. Matt satin aluminium reflector.

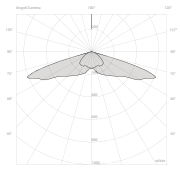

IP66 850° IK08

- 4000°K = standard
- 5000°K = +0.50% lm

W-Tot.	Lm (Tc=25°) 4000°K	Lm (Output)	Sost.	Dimension
90	13544	10699	250W merc-HG	D1
100	14922	11788	150W SAP-HPS	D1
120	16862	13320	250W JM-MH	D1
130	19445	15361	250W SAP-HPS	D1
150	21644	17098	400W JM-MH	D1
160	22483	17761	400W SAP-HPS	D1



## mod/E0

### Optiche e diffusori

Lenti stradali in PMMA con fascio per strade extraurbane. Asimmetria 60°. Riflettore in alluminio satinato.

### Louvers and diffusers

Road lenses in PMMA with highway beam. 60° asymmetry. Matt satin aluminium reflector.

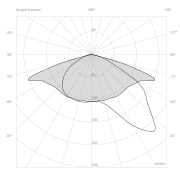

IP66 850° IK08

- 4000°K = standard
- 5000°K = +0.50% lm

W-Tot.	Lm (Tc=25°) 4000°K	Lm (Output)	Sost.	Dimension
90	13544	11158	250W merc-HG	D1
100	14922	12294	150W SAP-HPS	D1
120	16862	13892	250W JM-MH	D1
130	19445	16020	250W SAP-HPS	D1
150	21644	17832	400W JM-MH	D1
160	22483	18523	400W SAP-HPS	D1