

ARTEMIS

Double Basket LED Troffer



Applications: Office buildings, new and retrofit corporate fitouts, convenience stores, education and healthcare, supermarkets and retail

PERFORMANCE SUMMARY

Sunled's Artemis Series combines an optimal illumination design and contemporary styling with a soft, smooth and comfortable output.

It's high performance LEDs, advanced light distribution and attractive appearance deliver unprecedented energy savings, comfort and aesthetics outperforming fluorescent achieving best case watts-per-square foot scenarios.

Construction

- Slim 3.2" deep die-cast thick gauge aluminum alloy construction
- Extra-large back side access plates for easy installation and cable termination
- End plates securely attach for added stability eliminating gaps and light leakage
- White powder coat finish with corrosion pretreatment prevents blemishes and surface rust over time
- Surface, recessed or suspended installation
- Available in emergency battery backup option

Optics

- Available in 3500K, 4000K or 5000K with a minimum CRI of 82
- Advanced refractive optics deliver comfortable low brightness distribution for a wider, smoother and more uniform light output
- High transmittance frosted acrylics lens reduce glare and maintain an effective distribution
- 110°x110° beam angle

Electrical

- 100-277VAC
- Average rated life L80: >75,000H
- PF: > 0.95 THD: <20%
- Operating Temperature: -4°F to 122°F
- Environment Location: IP40
- 0-10V dimming

PRODUCT CODE

Example Artemis cat. 2/2.35.35.R.DIM.0



PHOTOMETRICS

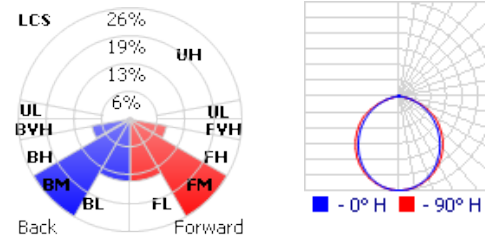

DIMENSIONS

2x4

19.8lbs (9.0kg)

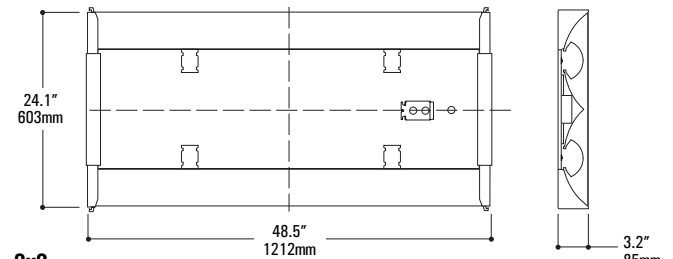

2x2

11.0lbs (5.0kg)

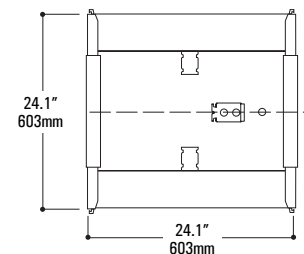

Model No	Dimension	Wattage (W)	CCT (°K)	Mounting	Dimming	Control
Artemis	1/4 - 1x4ft 11.6 x 48.5 x 3.2"	35 - 35W/3,600 lms	35 - 3500	R - Recessed	DIM - 0-10V Dimming	EM - 15W/90min Emergency
	2/2 - 2x2ft 24.1 x 24.1 x 3.2"	42 - 42W/4,350lms	4 - 4000	S - Surface	0 - None	0 - None
	2/4 - 2x4ft 24.1 x 48.5 x 3.2"	55 - 55W/5,660 lms	5 - 5000	SS - Suspended	0 - None	0 - None

