

PROFORMA PLUS

Multifunction Linear LED



Applications: Offices, education and healthcare, government, corporate, retail

PERFORMANCE SUMMARY

The Proforma Plus Linear Series is a specification line of linear products, created with architects and lighting designers in mind. It offers a full linear lighting portfolio that's extremely versatile and simple to design, configure and install.

Combining sleek seamless lines, brilliant color quality and ultra-smooth dimming, the Proforma Series is a modern solution designed to enhance both form and function.

Construction

- Flexible linear lighting family featuring elegant finishes, professional optics and unprecedented performance
- Simple joining and alignment mechanics optimize stability and straightness of patterns and continuous runs
- Pendant, surface or wall mounted installation offering full linear 2.3" portfolio, with multiple corner configurations to design an entire space
- Suspended installation employs aircraft cables that can be connected end to end with 6 different canopy options
- White or black fixture colors to complement every design and decor
- Enhanced design flexibility with 2', 3', 4' or 8' length increments
- Configurable for individual or continuous runs of up to 40' with 90° or 120° joiners
- Modular system allows easy access to critical components to simplify repair, installation or changeover

Optics

- 110° wide beam uplight distribution allows wider spacing between fixtures
- Selection of shielding options such as louvered, micro reflector deep recessed or wall wash
- 7 in 1 direct/indirect embedded lighting distribution controllable by adjustable DIP switch on pendant model
- Tunable CCT switch from 3000k to 3500k to 4000k

Electrical

- Class 2 high efficiency LED driver, with a standard 1-10V dimming
- Enhanced ultra smooth dimming down to 10% compatible with most Lutron and Leviton controllers
- 50 / 75 / 100% fully adjustable power selection switch

Specification

Volts: AC100-277

Beam Angle: Down 110° / Up 150°

Average Rated Life: 50,000hrs

THD: <20% PF: >0.9

Environment Location: Damp Location

Ambient temp: -20°C to 50°C

SDCM: <3 UGR: <22

CRI: RA80

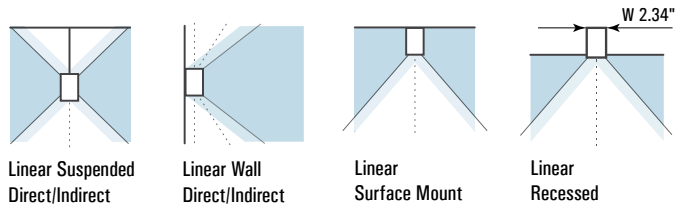

Beam Selectable

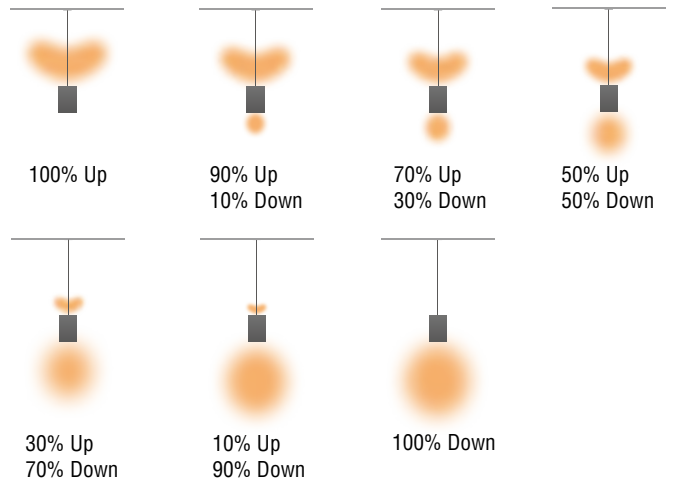

Shielding

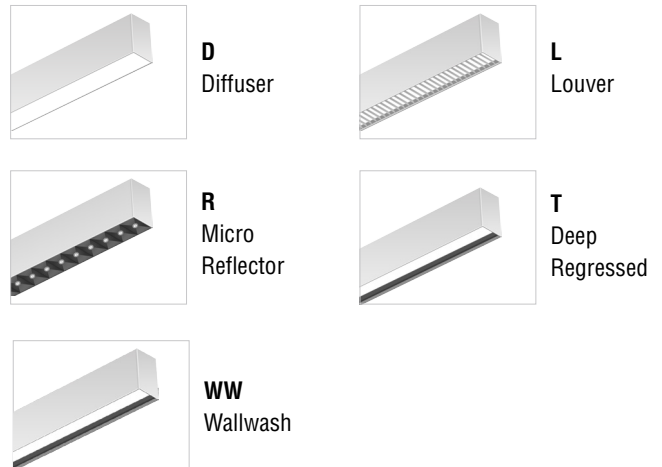

PROFORMA PLUS

Multifunction Linear LED

PRODUCT CODE

Example Proforma Plus cat. 2.20.W.345.R.A.P.4RN.D.0.0

Housing

Model	Length	Wattage (W)/ Lumens	Finish
Proforma Plus	2 - 2'	20 - 20W/2000lms	B - Black
	4 - 4'	40 - 40W/4000lms	W - White
	8 - 8'	80 - 80W/8000lms +PS - 50/75/100% Power Selectable	

Optics

CCT (°K)	Shielding	Distribution
345 - CCT Selectable 3/35/4000K	0 - None T - Deep Regressed L - Louver	A - Adjustable 7 Beam
35 - 3500 40 - 4000	R - Micro Reflector	

Installation

Mounting	Canopy ¹	Ceiling
P - Pendant	2RN - 2" Round Non Power	T - T Grid
S - Surface	4RP - 4" Round Power	D - Drywall
W - Wall Mounted	4RE - 4" Round Power EM Indicator	
R - Recessed Trim Kit	2SN - 2" Square Non Power 4SP - 4" Square Power 4SE - 4" Square Power EM Indicator 0 - None	

Accessories

Joints Non-Lit	Accessories
L - L Joiner	EM1 - 8W/90min Emergency
T - T Joiner	EM2 - 15W/90min Emergency
X - X Joiner	0 - None
Y - Y Joiner	
V - V Joiner	
I - I Joiner	
0 - None	

PRODUCT CODE

Example Proforma Plus R cat. 2.20.345.02.0.0.W.0

Model	Length	Output	CCT (°K)	Mounting	Lit Joints	Shielding	Trim	Emergency
Proforma Plus R - Recessed	2 - 2'	20 - 20W/2000lms	345 - CCT Selectable	T - T-Grid	L - L Joiner	T - Deep Regressed	B - Black	EM1 - 8W/90min Emergency
	3 - 3'	30 - 30W/3000lms	3/35/4000K	15/16" or 9/16" Trimless	I - I Joiner	WW - Wallwash	W - White	EM2 - 15W/90min Emergency
	4 - 4'	40 - 40W/4000lms		O2 - Hard Ceiling With Trim. Install From Below	0 - None	0 - None		0 - None
	8 - 8'	80 - 80W/8000lms +PS - 50/75/100% Power Selectable		F - Hard Ceiling Trimless Mud In				

NOTES:-

¹Standard configuration 1pc 4' AC power feed / 1pc 2' canopy

²Consult factory for DLC options



PROFORMA PLUS

Multifunction Linear LED

DIMENSIONS

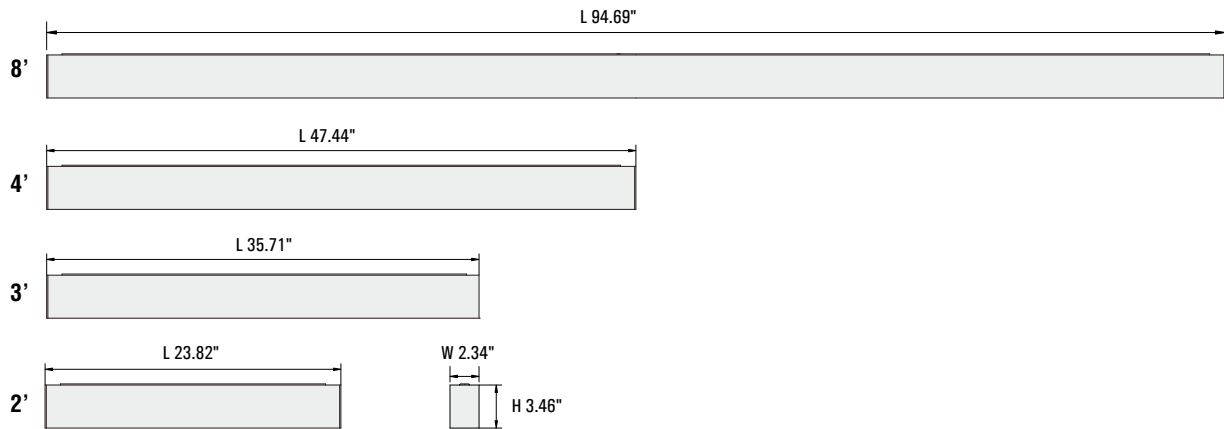

LINKAGE

Single

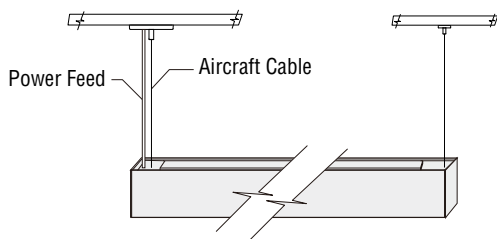

Continuous

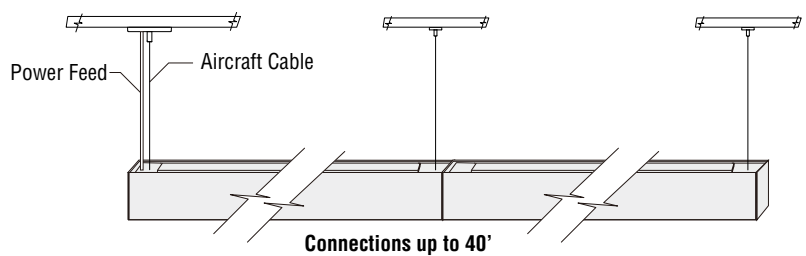

PHOTOMETRICS

Micro Reflector

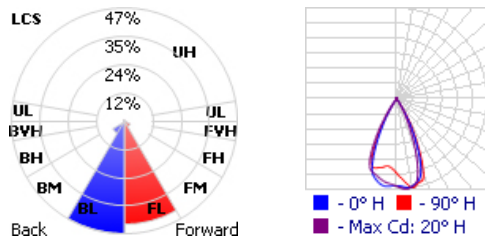

Diffuser

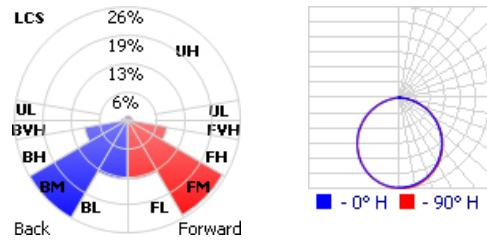

Deep Regressed

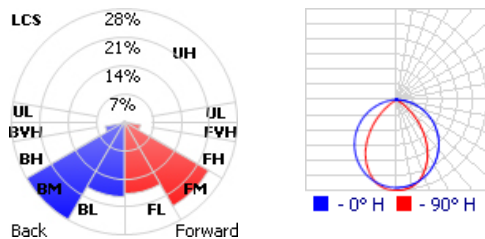

Louver

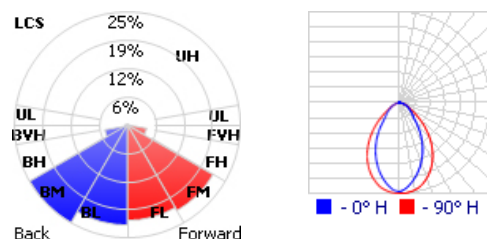

PROFORMA PLUS

Multifunction Linear LED

CANOPY

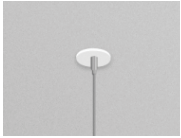

2RN
2" Round
Non Power

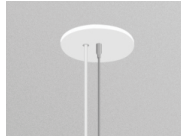

4RP
4" Round
Power

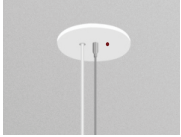

4RE
4" Round
Power / EM
Indicator



T
T Grid

RECESSED



O2
Hard Ceiling
With Trim,
Install Below

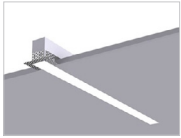

F
Hard Ceiling
Trimless
Mud-in Kit

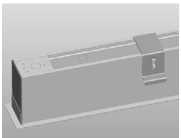

T
T-Grid Trimless
15/16" or 9/16"

T-Grid

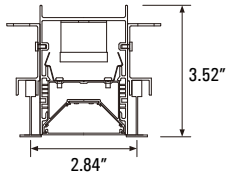

9/16" Flat

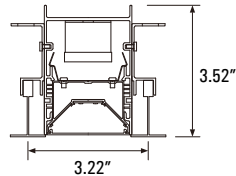

15/16" Flat

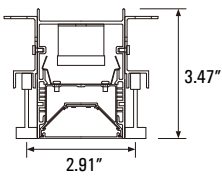

9/16" Slot-1

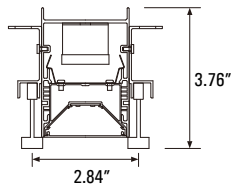

9/16" Slot-2

Drywall Mud-In

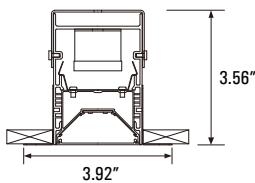

CONNECTOR



I
I Joiner



L
L Joiner



T
T Joiner



X
X Joiner



Y
Y Joiner



V
V Joiner

JOINTS

For shape please draw your layout sketch as below including linear lengths on all sides, part no and designated shape type, or consult factory for a detailed quotation

Shape Diagram



Eg. Proforma Plus Type A
40 35 W C
Direct Direct Finish Mounting
Indirect Indirect
Watt CCT

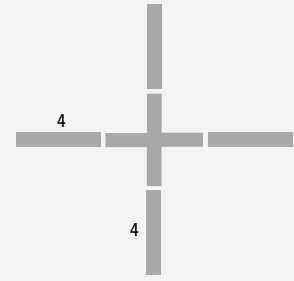

Eg. Proforma Plus Type B
cat. 40.35.W.C

PROFORMA PLUS

Multifunction Linear LED

MOUNTING DETAIL

12'

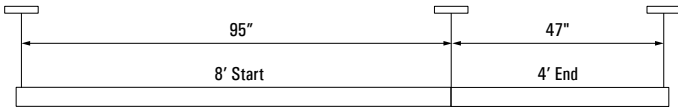

16'

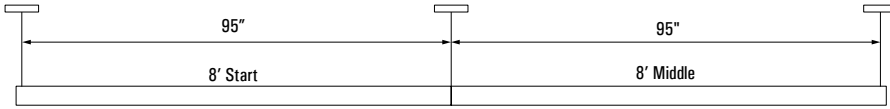

20'

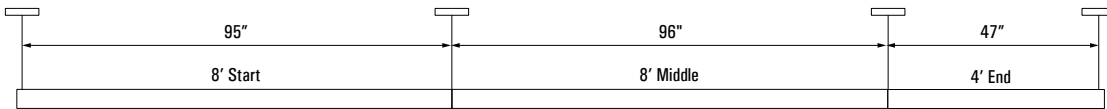

24'

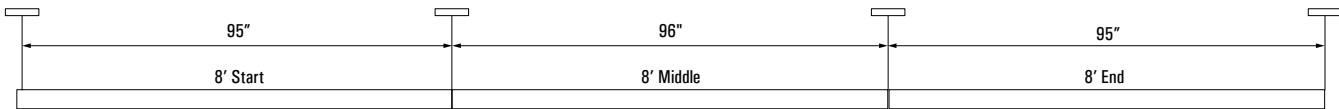

NOTE

Consult factory for additional row mounting information