



QS-HYE



Application: Warehouses, gymnasiums, production assembly areas, and any high ceiling applications.

DESCRIPTION

The QS-HYE Series round highbay LED luminaries are slim, sleek and lightweight for easy installation, suitable at up to 35' mounting heights. The QS-HYE delivers efficient uniform light with a 50K hour life rating featuring Watt and CCT selectable lamps and internal heat sink

FEATURES

- Twist on microwave motion sensor
- Adjustable wattage to meet different customer demands
- Internal cooling fins provide maximum heat dissipation for higher ambient temperatures
- Die cast hook mount standard for ease of installation
- 1/2" threaded hub for pendant mount applications
- Impact resistant glass lens with 90% light pass rate
- Includes 6' power and dimming cord with leads
- Lightweight and minimalistic

SPECIFICATION

Volts: 100-277VAC

CCT: Selectable: 3000K-4000K-5000K

Average Rated Life: L70/50,000hrs

Ambient temp: -4°F to 113°F

Beam Angle: 110°

PF: >0.9 THD: <20%

CRI: >80

ORDERING CODE

LED ROUND HIGH BAY

QS-HYE

345

U

PC

B

D

QS-HYE

Quickship Series

QS-HYE Quickship HYE

Output

150	100/120/150W 14,000/16,800/21,000Lm
240	150/200/240W 21,000/28,000/33,600Lm
300	260/280/300W 36,400/39,200/42,000Lm

345

LED CCT

345 3000/4000/5000K

U

Voltage

U Universal 110V – 277V

PC

Direct Optics

PC Polycarbonate Lens

Mounting

H Hook
R Ring

B

Finish

B Black

D

Dimming

D Dimmable

Control

NP Blank/No Sensor
MS Microwave Sensor



100 Duffy Ave, Hicksville NY 11801 . Phone: 917.563.7078 . www.sunledind.com
© 2024 Sunled Industries LLC. All Rights Reserved



Max Order Size 200pcs

QS-HYE

DIMENSIONS



ORDERING CODE

LED ROUND HIGH BAY

QS-HYE

345

U

PC

B

D

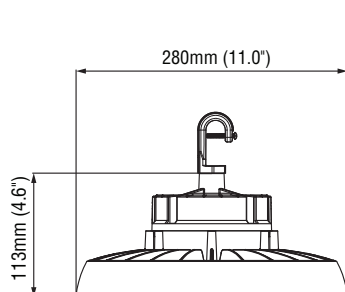

100/125/150W
Hook Mount

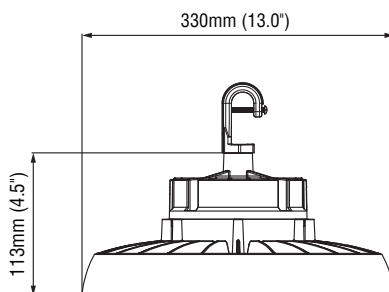

150/200/240W
Hook Mount

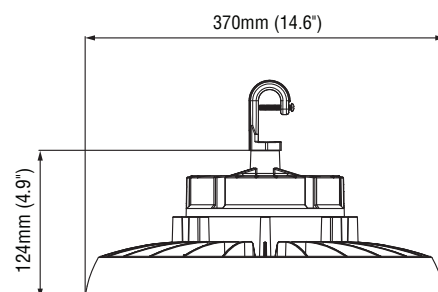

260/280/300W
Hook Mount

WIRING CONNECTION

Turn off the power before installation

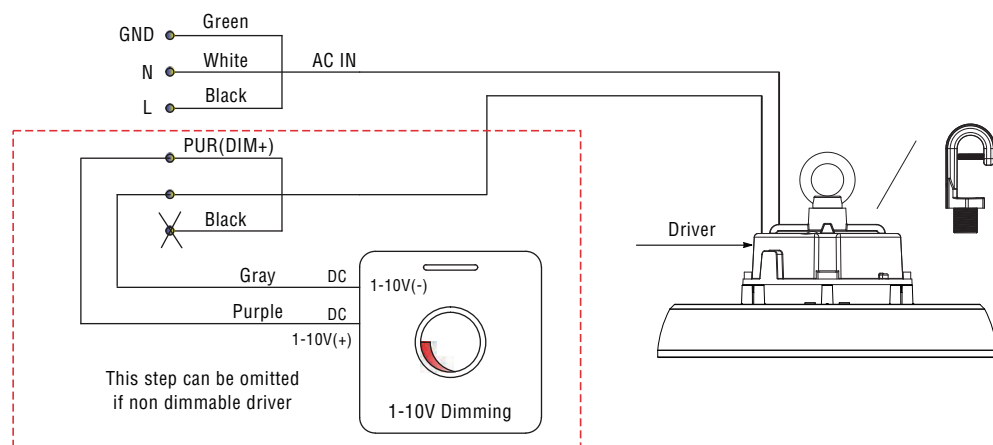

WATT & CCT SELECTABLE

1. Remove the waterproof rubber cover from wattage box

2. Select wattage using the slider switch

3. Replace the waterproof rubber cover

