

# SPARROW

Architectural Floodlight



**Applications:** Site perimeters, building projection, parks, facades, infrastructure, entrances, commercial and architectural spaces

## PERFORMANCE SUMMARY

Sparrow floodlights provide seamless solutions for a multitude of outdoor and architectural applications.

These floodlights are characterized by a long service life, wide range of beam angles, choice of horizontal or vertical mounting configurations and shield add-ons that further optimize the optical system

## Features

- Tempered glass lens cover
- Surface finished with a proprietary Akzo Nobel treatment, withstanding harsh weather conditions without cracking or peeling
- Available in 5 distributions for precise optical control
- 240V or 24V DC RGB colour changing option, with built in decoder and interface to DMX system
- Side shield housing addon available
- Pedestal or yoke mounting bracket
- Dimmable

## Specification

Volts: AC100-277V or DC24V  
 PF: >0.95  
 Average Rated Life: 90,000hrs  
 CRI: RA80  
 Environment Location: IP65  
 Ambient temp: -4°F to 113°F



## DIMENSIONS

Weight (May vary with accessories)  
 18.3lbs (8.3kg)

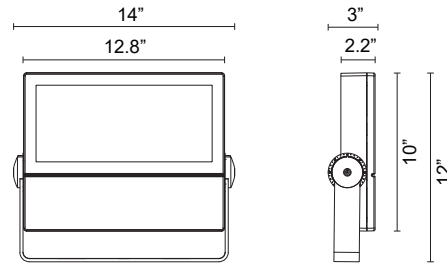

## PRODUCT CODE

Example Sparrow 120 cat. C75.3.25.80.YK.B.VS/M

Model No	Wattage (W)	CCT (K)	Ra	Beam Angle	Mounting	Housing Color	Accessories
Sparrow 120 AC120V	C75 - 75W/7500lm C100 - 100W/10,000lm	3 - 3000 4 - 4000	80 - RA80	10 - 10° 25 - 25°	YK - Yoke PD <sup>1</sup> - Pedestal	B - Black RAL9011	VS - Visor DIM - 0-10V Dimming
Sparrow 24 DC24V	C150 - 150W/15,000lm	6 - 6000		50 - 50° 65 - 65° 96 - 96°		W - White RAL9016 G - Gray RAL7012 M - Mineral Bronze S - Silver RAL9006	M - Marine Corrosion Resistant O - None

## NOTES

<sup>1</sup>Pedestal suitable for horizontal surface only



# SPARROW

Architectural Floodlight

## BEAM ANGLE

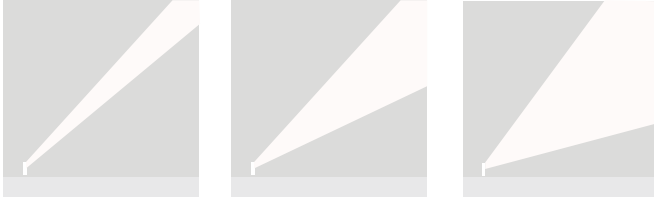

10°

25°

50°



65°

96°

## OPTIONS



YK Yoke



PD Pedestal



VS Visor

## INSTALLATION

### Pedestal

- (1) Open the package, remove contents and installation manual
- (2) Loosen screws on pedestal hinges to avoid damage during adjustment
- (3) Fix the mounting base with supplied screws on a horizontal mounting surface, adjust the head
- (4) Tighten screws on pedestal hinge

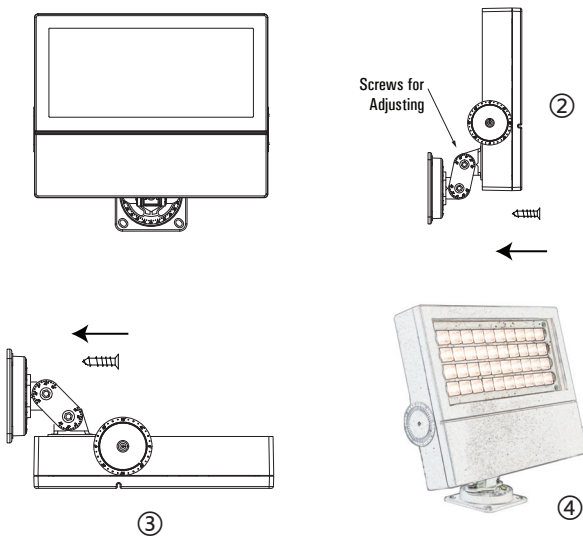

### Yoke

- (1) Open the package, remove contents and installation manual
- (2) Loosen screws on yoke hinges and detach from head
- (3) Fix the yoke with supplied screws on a horizontal or vertical mounting surface
- (4) Reattach yoke, adjust the head
- (5) Tighten screws on yoke hinge

